

Bike Parking Compound - Carpark Level -1 Plan
1:100

Row	Rack Capacity	Quad-Racks	Bike Parking Spaces
A	4	18	72
B	4	11	44
C	4	11	44
D	4	10	40
E	4	10	40
F	4	11	44
G	4	11	44
H	4	11	44
I	4	11	44
J	4	8	32
K	4	4.5	18
L	4	9	36
TOTAL			502

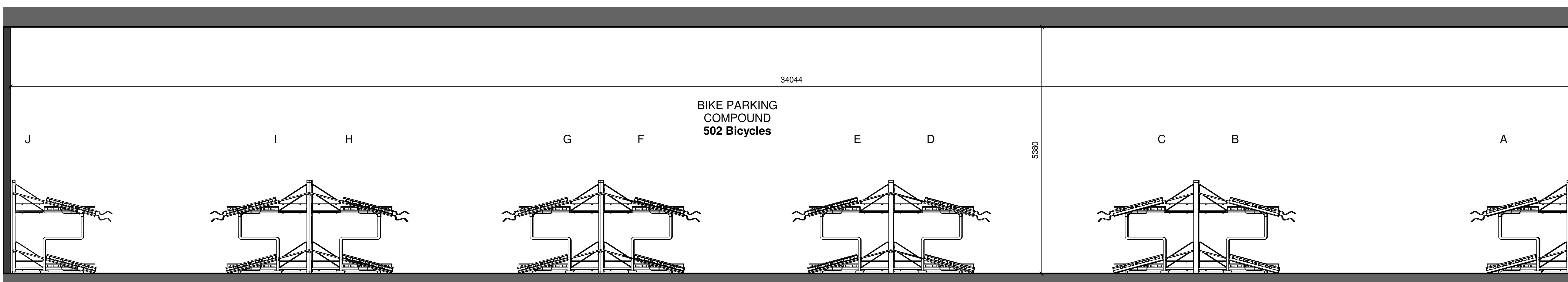

SECTION
1:50

EXAMPLE OF RACK

QUAD-RACK™ DIMENSION DRAWINGS:

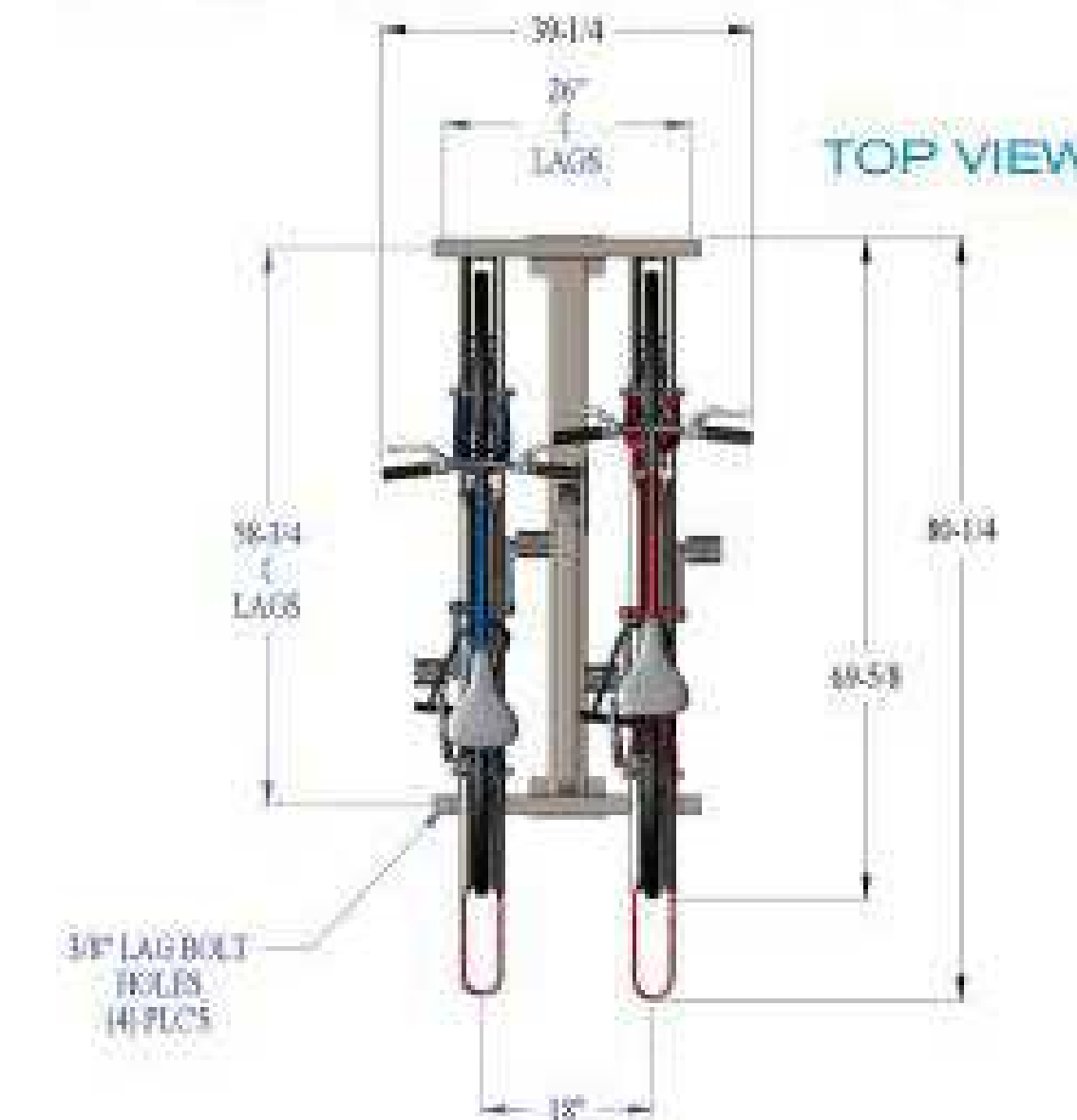

Product: Quad-Rack Hi-Density Rack
Capacity: Each section holds 4 bicycles, modular for expansion
Material: Silver Powdercoat steel with extruded PVC channels
Recommended Lock: High quality U/Lock or chain
Custom Colors: On request

HI-DENSITY RACK by CycleSafe

FRONT VIEW

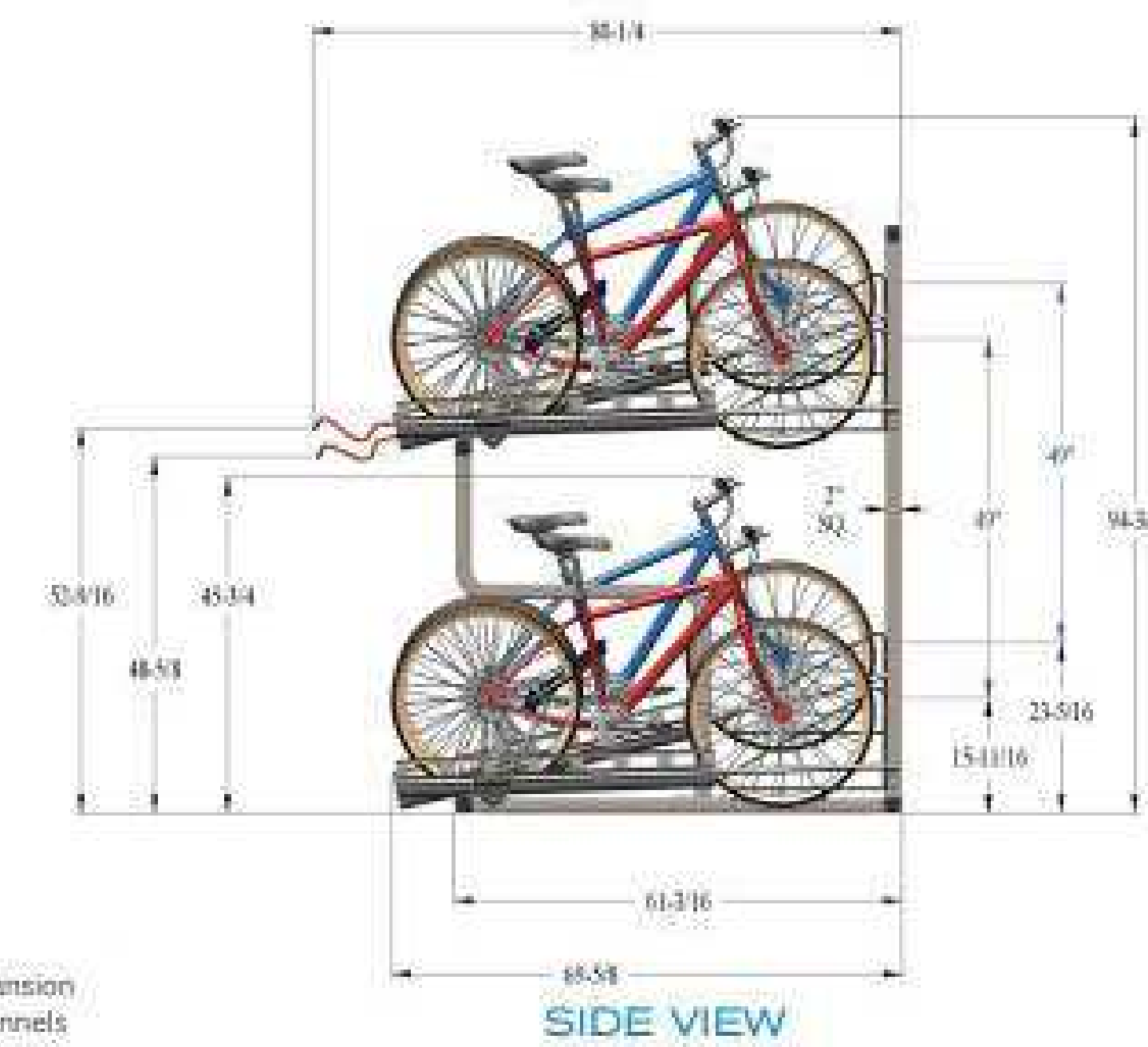
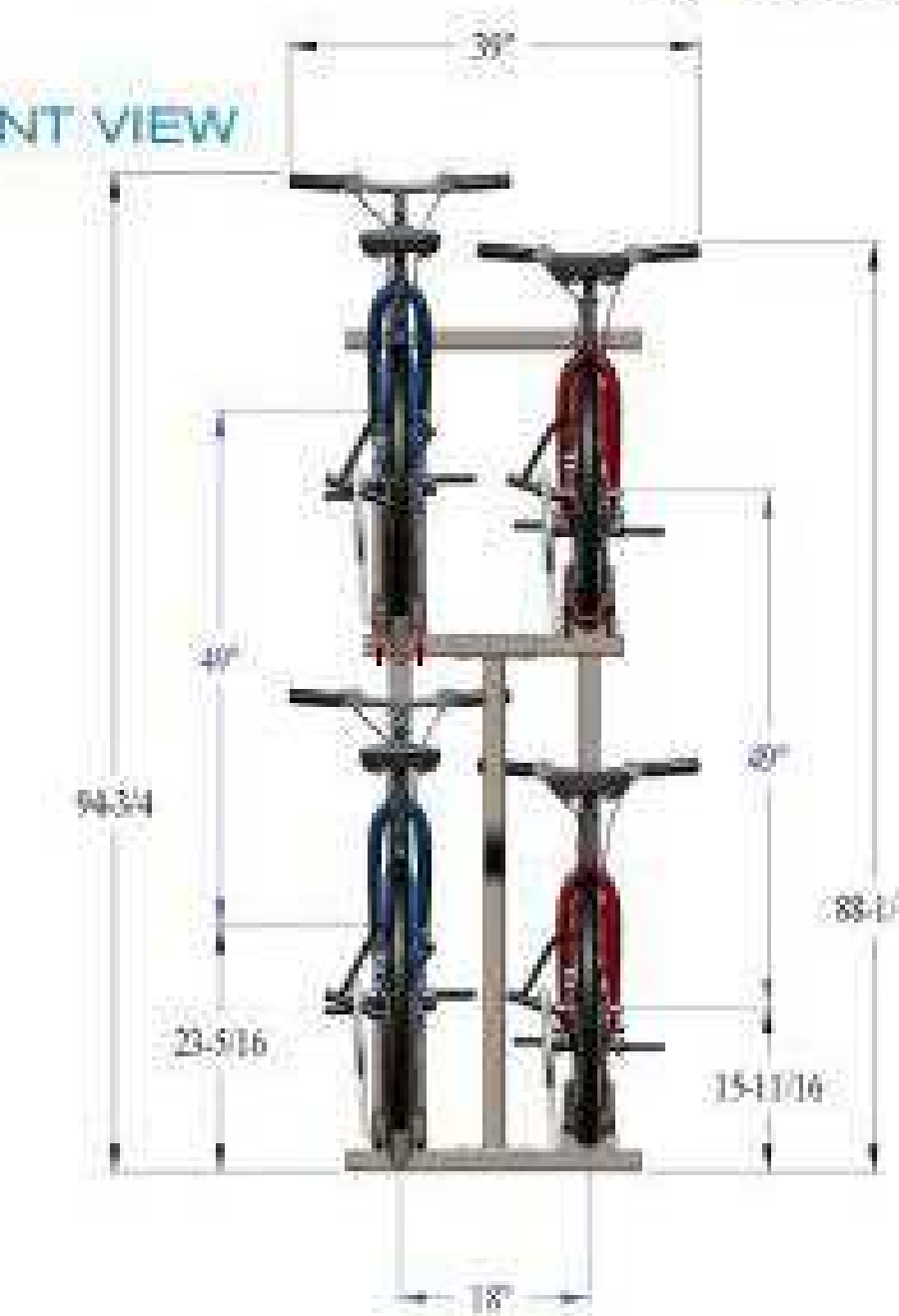

SIDE VIEW

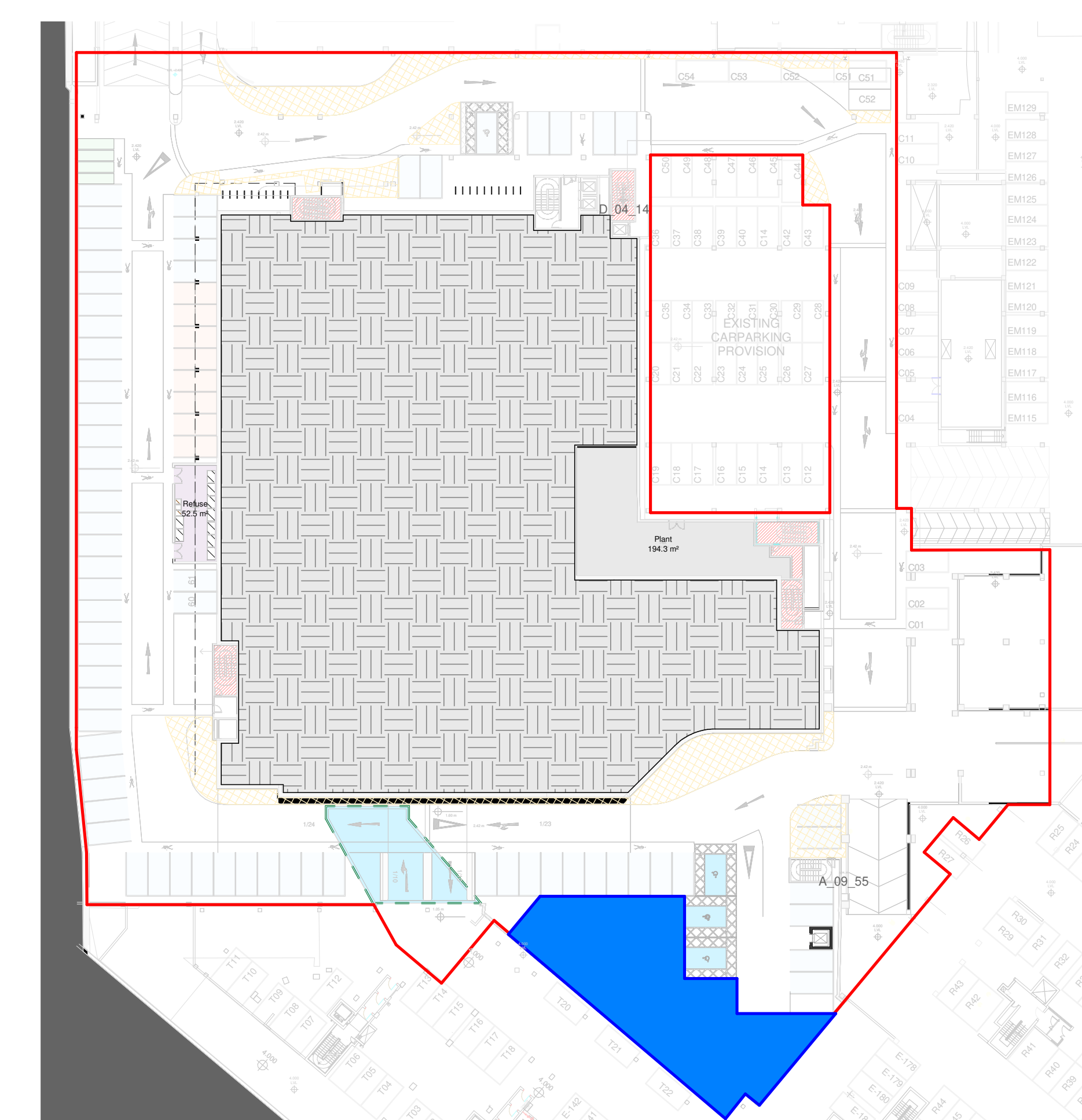

BASEMENT KEY PLAN - COMPOUND IN BLUE
1:500

Notes:
DO NOT SCALE FROM THIS DRAWING. USE FIGURED DIMENSIONS
IN ALL CASES. VERIFY DIMENSIONS ON SITE AND REPORT ANY
DISCREPANCIES TO THE ARCHITECTS IMMEDIATELY. THIS
DRAWING TO BE READ IN CONJUNCTION WITH THE ARCHITECTS
SPECIFICATION. © THIS DRAWING IS COPYRIGHT AND MAY ONLY
BE REPRODUCED WITH THE ARCHITECTS PERMISSION.

001 License Number: AP 0002219
Projection / Spatial Reference:
Projection: IRTM27R, Irish Transverse Mercator
Centre Point Coordinates:
X Y: 71623.187, 73478.133
Reference Index:
Map Series / Map Sheets:
1:1000 1283-08
1:1000 1284-06
1:1000 1283-04
1:1000 1284-01
1:1000 1283-05
1:1000 1283-10
Vertical Datum:
MALIN HEAD

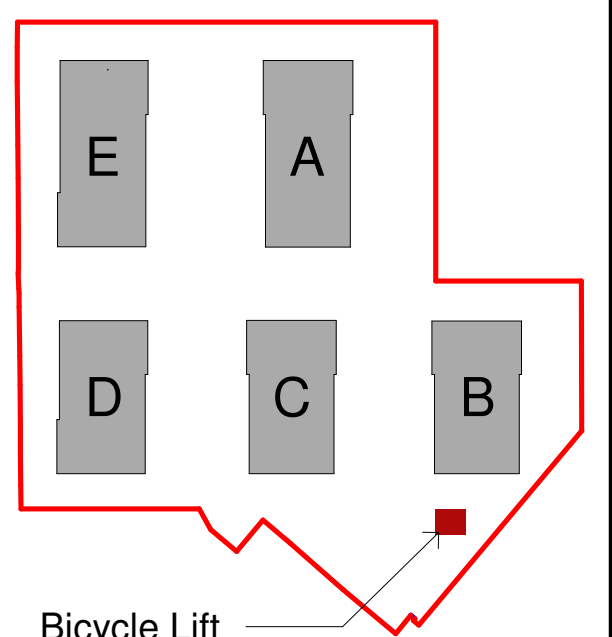
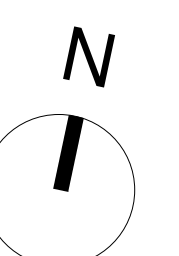

Bicycle Lift

P01 02/07/21 EOB Issued for Planning

Rev	Date	DRN	Description

reddy architecture + urbanism
reddy architecture + urbanism
Dany Road
Dublin 6, D06 Y9E3
T: +353 (0)1 4887000
W: www.reddyarchitecture.com
E: info@reddyarchitecture.com

Client Details:
HPREF HSQ Investments Limited

Project Details:
HSQ Feasibility
Heuston South Quarter, St John's Rd W,
Kilmainham, Dublin 8

Drawing Title:
Proposed Basement Bicycle Parking Compound

Job No	Date	Scale(s)
P19-213D	17/09/21	1:500 / 1:100 / 1:50

Status	Drawn By
Planning permission	LH

Purpose	Checked By
Planning permission	EOB

Drawing Number	Revision
RAU-ZZ-00-DR-A-GAP-06133	P 01